

## STEEL STRUCTURE WORKSHOP

### GARAGE BUILDING

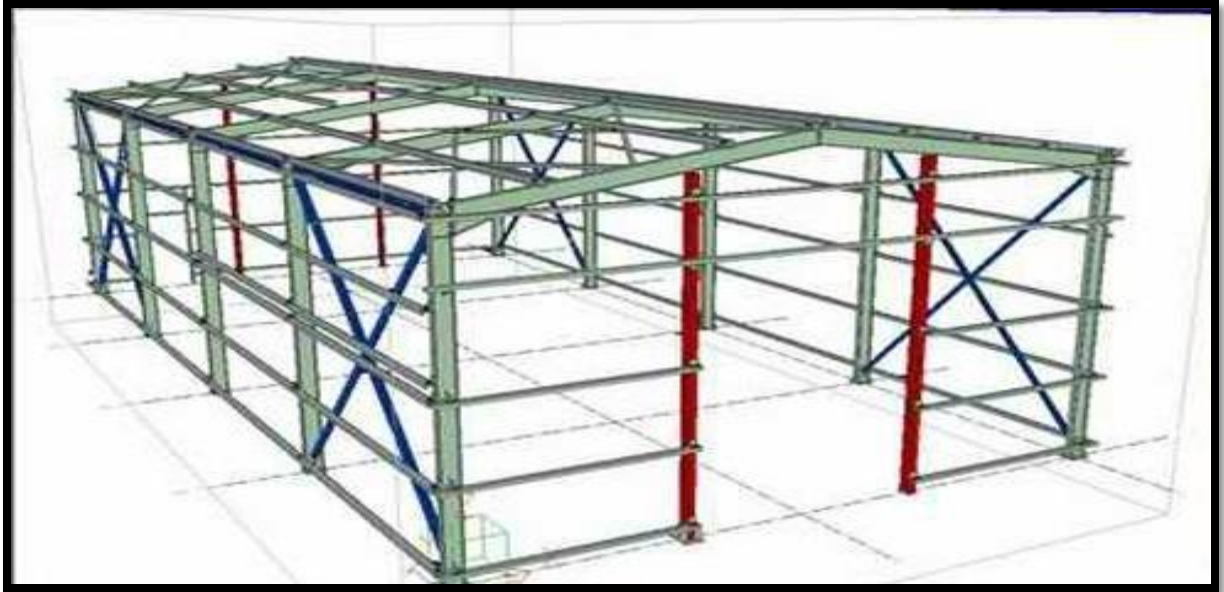

Steel Structure Workshop Garage Building could design in large span , the building could design in single span or multi-span , each span max wide could reach 36m without middle column , steel structure with the advantage of light dead weight and great strength can resists the impact of strong wind and seismic performance and bears heavy snow loads.

